



28 Surrey Street, Luton, LU1 3BZ

An excellent opportunity to acquire this well presented two bedroom mid terraced home, ideally situated within easy reach of Luton town centre and the mainline station.

The accommodation comprises a spacious through lounge with an open plan stairway, fitted kitchen, two good sized bedrooms and a family bathroom. The property further benefits from double glazing gas central heating and a well maintained rear garden and is presented in good order throughout, making it suitable for both owner occupiers and investment buyers alike.

The property is currently tenanted, generating £1,100 PCM with the tenants expressing an interest in remaining at the property, offering an attractive ready made investment opportunity. Alternatively, vacant possession can be provided if required.

*Sale by tender

£215,000

- Nova Estate Agents
- Press Play Button For 360° Walkaround Tour
- Two Bedroom Home
- Currently Let at £1100pcm
- Chain Free!
- Walking Distance to Town Centre
- Double Bedrooms
- Open Plan Lounge/Diner
- Open House 14.5.26

Approx Gross Internal Area
62 sq m / 663 sq ft

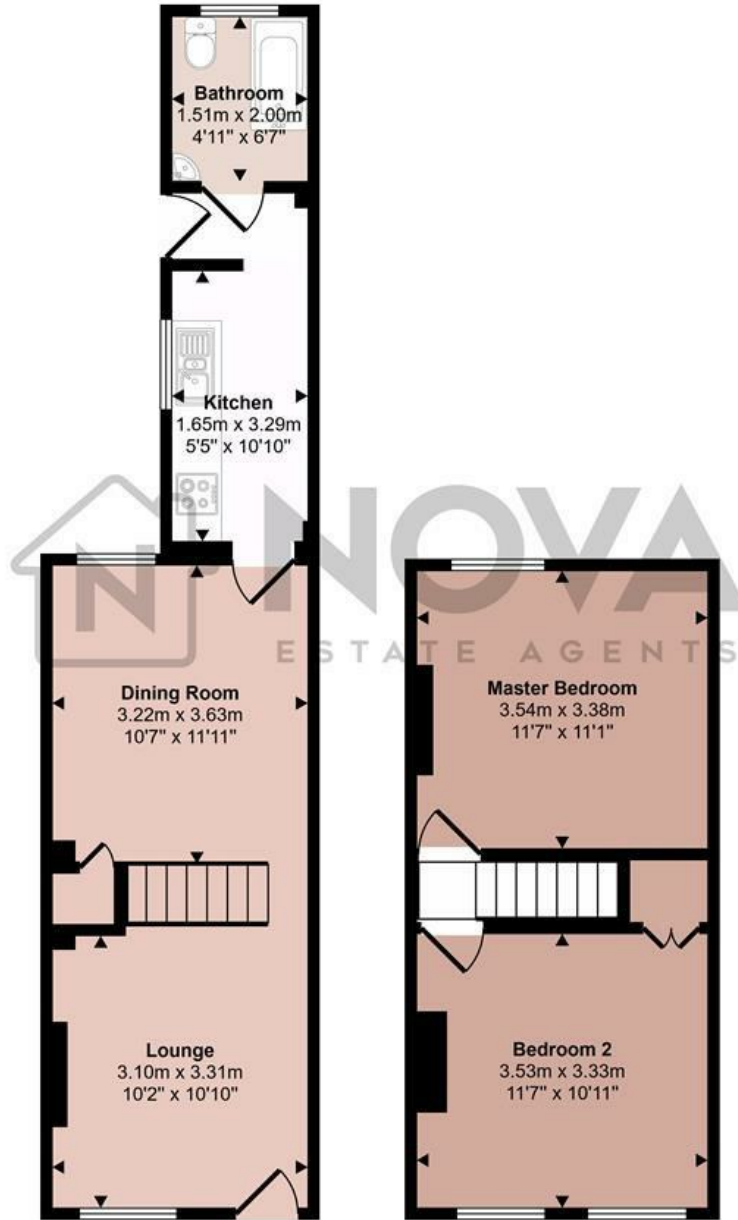

Ground Floor
Approx 34 sq m / 368 sq ft

First Floor
Approx 27 sq m / 295 sq ft

This floorplan is only for illustrative purposes and is not to scale. Measurements of rooms, doors, windows, and any items are approximate and no responsibility is taken for any error, omission or mis-statement. Icons of items such as bathroom suites are representations only and may not look like the real items. Made with Made Snappy 360.

Energy Efficiency Rating		Current	Potential
Very energy efficient - lower running costs			
(92 plus) A			88
(81-91) B			
(69-80) C			
(55-68) D		61	
(39-54) E			
(21-38) F			
(1-20) G			
Not energy efficient - higher running costs			
England & Wales		EU Directive 2002/91/EC	